

# Fuel Pressure Regulator Mini 2



- ▶ 5 to 8 bar
- ▶ 30 to 400 l/h reflow
- ▶ Adjusted at 105 l/h
- ▶ Aluminum housing
- ▶ All versions Methanol compatible

Fuel pressure regulators are used to maintain constant fuel pressure at the injection valves. We offer this regulator for gasoline as well as for methanol applications. The main benefit of this regulator includes a higher pressure range and a higher return flow rate in comparison to the production type regulators.

## Application

Pressure range	See ordering information
Reflow quantity	30 to 400 l/h
Fuel compatibility	Gasoline, E85, M100
Operating temperature	-40 to 120°C
Storage temperature	-40 to 100°C
Max. vibration	<600 m/s <sup>2</sup> at 5 to 250 Hz
Valve leakage	$Q_{leak} [\text{cm}^3/\text{min}] \leq 9$ (pneumatic) at $p [\text{kPa}] = 0.8 \times P_{nom}$

## Technical Specifications

### Mechanical Data

Diameter	38.1+0.1-0.2 mm
Weight	Ca. 61 g
Mounting	Fastening with a clip

### Connectors and Wires

Connector supply	Diam. 25 mm, O-ring 25x2.5
Connector reflow	Diam. 9.1 mm, O-ring 5x2.5

## Installation Notes

- Never run the regulator without the integrated filter.
- Please oil O-rings lightly with clean and silicone free engine oil before you install the regulator.
- Please make a leak test after you have installed the regulator.
- When the pressure regulator is removed and will be reused, the O-rings must be tested for fractures.
- Operation of the pressure regulator with a medium other than gasoline is not allowed.
- Using the FPR Adaptor light F02U.V02.248-01, you can rebuild the regulator an inline type.
- This pressure regulator is not designed for in-tank mounting.

## Legal Restrictions

Due to embargo restrictions, sale of this product in Russia, Belarus, Iran, Syria, and North Korea is prohibited.

## Ordering Information

### Fuel Pressure Regulator Mini 2

Pressure Range 5.0 bar  
Order number **F02U.V02.166-01**

### Fuel Pressure Regulator Mini 2

Pressure Range 6.0 bar  
Order number **F02U.V02.168-01**

### Fuel Pressure Regulator Mini 2

Pressure Range 7.0 bar  
Order number **F02U.V02.170-01**

### Fuel Pressure Regulator Mini 2

Pressure Range 8.0 bar  
Order number **F02U.V02.171-01**

## FPR Adaptor Light

Order number F02U.V02.248-01

## Dimensions

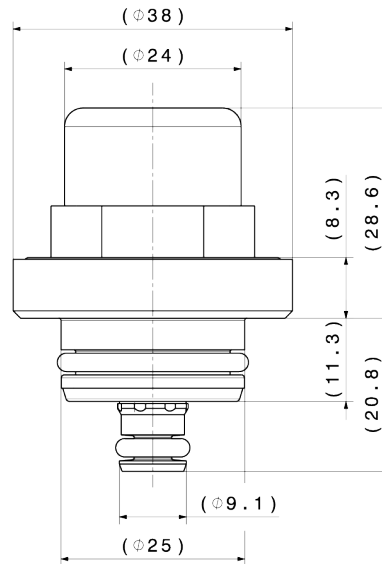
Complete dimensions on offer drawing at [www.bosch-motorsport.com](http://www.bosch-motorsport.com)

## Represented by:

**Europe:**  
 Bosch Engineering GmbH  
 Motorsport  
 Robert-Bosch-Allee 1  
 74232 Abstatt  
 Germany  
 Tel.: +49 7062 911 9101  
 Fax: +49 7062 911 79104  
[motorsport@bosch.com](mailto:motorsport@bosch.com)  
[www.bosch-motorsport.de](http://www.bosch-motorsport.de)

**North America:**  
 Bosch Engineering North America  
 Motorsport  
 38000 Hills Tech Drive  
 Farmington Hills, MI 48331-3417  
 United States of America  
 Tel.: +1 248 876 2977  
 Fax: +1 248 876 7373  
[motorsport@bosch.com](mailto:motorsport@bosch.com)  
[www.bosch-motorsport.com](http://www.bosch-motorsport.com)

**Asia-Pacific:**  
 Bosch Engineering Japan K.K.  
 Motorsports Department  
 1-9-32 Nakagawa Chuo, Tsuzuki-ku  
 Yokohama City  
 Kanagawa Prefecture 224-8601  
 Japan  
 Tel.: +81 45 605 3032  
 Fax: +81 45 605 3059  
[www.bosch-motorsport.jp](http://www.bosch-motorsport.jp)

**Australia, New Zealand and South Africa:**  
 Robert Bosch Pty. Ltd  
 Motorsport  
 1555 Centre Road  
 Clayton, Victoria, 3168  
 Australia  
 Tel.: +61 (3) 9541 3901  
[motor.sport@au.bosch.com](mailto:motor.sport@au.bosch.com)